

CAULK-CONTINUOUS BEAD
WOOD-TO-WOOD CONNECTIONS - TYP.

8d NAILS OR # 14 1 1/2"
STAPLES- 6"O.C.- TYP.

FOAM SEALANT-CONTINUOUS BEAD-
EPS-TO-WOOD - TYP.

14 PANEL SCREW 1 1/2"
LONGER THAN PANEL THICKNESS
SEE ENGINEERING DATA FOR
SPACING REQUIREMENTS

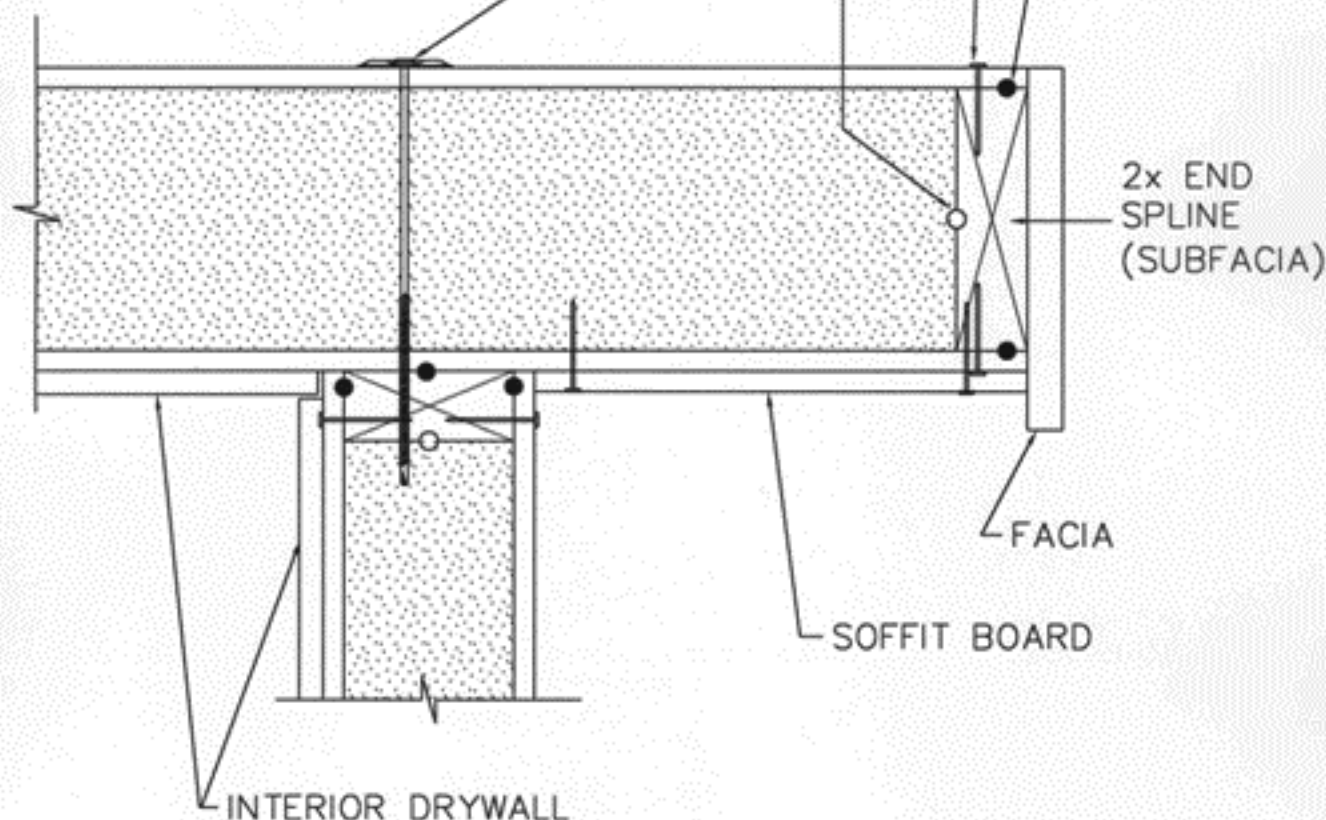

STRUCTURAL INSULATED PANEL
INSTALLATION GUIDE

TITLE

ROOF-TO-WALL CONNECTION
GABLE END

PORTER
STRUCTURAL INSULATED PANELS

V. H. PORTER, INC. 4240 N. 130th AVE HOLLAND, MI 49424 (616) 399-1983
11/02

38-308